

SGIH Parting Tools (Depth < 40mm)

SGIH 切斷刀 (切深 < 40mm)

External Tool Holder Specifications 外徑刀桿規格

SGIH

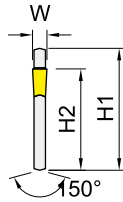

Insert Brand : Winstar, Iscar, ...

| Order No. | Dimensions (mm) | | | | Insert | Tool Block | Wrench |
|-----------|-----------------|------|-----|-----|----------|--------------|--------|
| | H1 | H2 | L | W | | | |
| ISGIH26-2 | 26 | 21.4 | 110 | 2.2 | TGTN0220 | ISGTBU...-26 | IESG-1 |
| ISGIH26-3 | 26 | 21.4 | 110 | 3.1 | TGTN0310 | | |
| ISGIH26-4 | 26 | 21.4 | 110 | 4.1 | TGTN0410 | | |
| ISGIH32-2 | 32 | 25 | 150 | 2.2 | TGTN0220 | ISGTBU...-32 | |
| ISGIH32-3 | 32 | 25 | 150 | 3.1 | TGTN0310 | | |
| ISGIH32-4 | 32 | 25 | 150 | 4.1 | TGTN0410 | | |

SGTBU

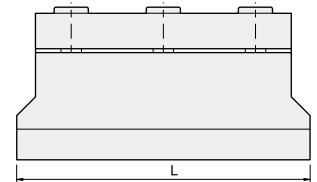
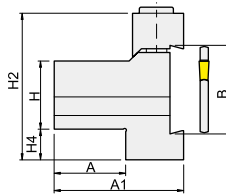

| Order No. | Dimensions (mm) | | | | | | | Screw | Wrench | BLADE |
|-------------|-----------------|----|----|----|-----|----|----|---------|--------|-----------|
| | H | B | A | A1 | L | H2 | H4 | | | |
| ISGTBU20-26 | 20 | 26 | 21 | 38 | 86 | 43 | 9 | IHTM630 | IPL50 | ISGIH26-3 |
| ISGTBU25-26 | 25 | 26 | 23 | 40 | 86 | 43 | 4 | | | ISGIH32-3 |
| ISGTBU20-32 | 20 | 32 | 21 | 40 | 110 | 50 | 13 | | | |
| ISGTBU25-32 | 25 | 32 | 23 | 42 | 110 | 50 | 8 | | | |

SGTHR

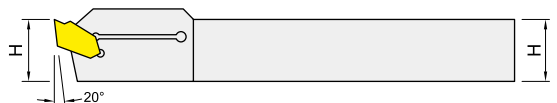
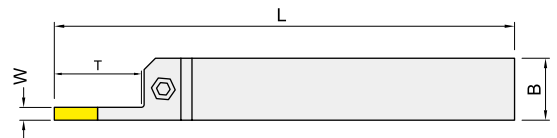

| Order No. | Dimensions (mm) | | | | | Insert | Screw | Wrench |
|-------------|-----------------|----|-----|---|----|----------|---------|--------|
| | H | B | L | W | T | | | |
| ISGTHR16162 | 16 | 16 | 110 | 2 | 16 | TGTN0220 | IHTM521 | IPL40 |
| ISGTHR20202 | 20 | 20 | 125 | 2 | 18 | | | |
| ISGTHR20203 | 20 | 20 | 125 | 3 | 20 | TGTN0310 | IHTM625 | IPL50 |
| ISGTHR25253 | 25 | 25 | 150 | 3 | 25 | | | |
| ISGTHR25254 | 25 | 25 | 150 | 4 | 30 | | | |

Recommended Cutting Conditions 建議切削數據

| Working Material | Vc (m/min) | Parting off, fr (mm/rev) | | |
|----------------------------|---------------|--------------------------|-------------|-------------|
| | | Cutting Width (w) | | |
| | | 2 | 3 | 4 |
| Carbon Steel / Alloy Steel | 80 ~ 200 | 0.02 ~ 0.14 | 0.03 ~ 0.21 | 0.04 ~ 0.28 |
| Stainless Steel | 60 ~ 140 | 0.02 ~ 0.10 | 0.03 ~ 0.15 | 0.04 ~ 0.20 |
| Cast Iron | 80 ~ 200 | 0.04 ~ 0.14 | 0.06 ~ 0.21 | 0.08 ~ 0.28 |
| High Temperature Alloy | 50 ~ 100 | 0.02 ~ 0.06 | 0.03 ~ 0.09 | 0.04 ~ 0.12 |

Insert Specifications 刀片規格

| Insert | Dimensions (mm) | |
|----------|-----------------|------|
| | w | r |
| TGTN0220 | 2.2 | 0.2 |
| TGTN0310 | 3.1 | 0.2 |
| TGTN0410 | 4.1 | 0.25 |

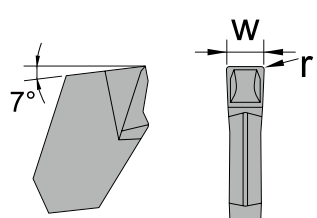

Insert Designation 刀片型號

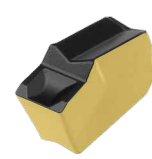
| Inserts | Order No. | Code-Grade | Working Material | | | | | |
|--|---------------|-----------------|------------------|---|---|---|---|---|
| | | | P | M | K | N | S | H |
|  | ITGTN022033TX | TGTN0220-CX33TX | ● | ● | ● | | ● | ● |
| | ITGTN022043TX | TGTN0220-CX43TX | ● | ● | ● | | ○ | |
| | ITGTN022047TA | TGTN0220-CX47TA | ● | ● | ● | | | |
| | ITGTN031033TX | TGTN0310-CX33TX | ● | ● | ● | | ● | ● |
| | ITGTN031043TX | TGTN0310-CX43TX | ● | ● | ● | | ○ | |
| | ITGTN031047TA | TGTN0310-CX47TA | ● | ● | ● | | | |
| | ITGTN041033TX | TGTN0410-CX33TX | ● | ● | ● | | ● | ● |
| | ITGTN041043TX | TGTN0410-CX43TX | ● | ● | ● | | ○ | |
| | ITGTN041047TA | TGTN0410-CX47TA | ● | ● | ● | | | |

* CX33TX for General cutting.
 CX43TX for Interrupted cutting.
 CX47TA for Heavy interrupted cutting.